

FDA CE

Tomato  **CAST**™
Orthopedic Casting Tape

POLYESTER / FIBERGLASS
SOFT / RIGID
SAFE PAD
PATTERNED CAST

Tomato  **SPLINT**™
Orthopedic Splint

PRE-CUT&ROLL TYPE ORTHOPEDIC SPLINT
POLYESTER / FIBERGLASS / NON WOVEN FABRIC

Tomato ^{SAFE} CAST™

FEATURES

- Comfortability: Smooth unrolling offers doctors can wrap it with less pressure and patient will have no pains during the applying procedure.
- Conformability and mouldability : Our own produced extreme soft fabric makes it easier to wrap and shape the contours of the human body.
- Durability for safety: Tomato Cast is strong to impact and durable on the edges.
- Tack-free and no layer separation
- Excellent X-ray translucency

APPLICATION INSTRUCTIONS

Please refer to our websites (www.tomatomnc.com) for instruction video and more details.



- 1** Slip the two layers of Tomato SAFE Pad on the affected body part.

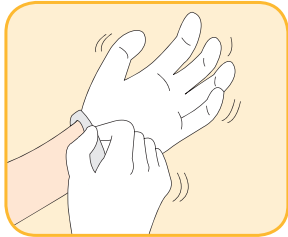

- 2** Gloves must be worn.

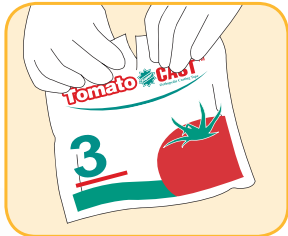

- 3** Open only one roll of Tomato Cast at a time.

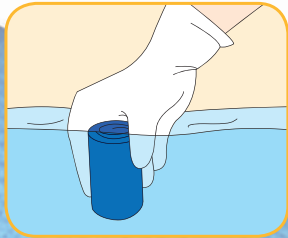

- 4** Immerse the roll in the water in a temperature of 20~24 degrees for 3~5 seconds and squeeze 3~4 times in the water for the complete water penetration into the body of the roll. This process will help strengthen adhesion and make it easy to come off the roll.
* Do not put it in the water for too long.



- 5** Wrap spirally, taking care to avoid excessive tightness.
* Finish wrapping it up within 1 minute and 10 seconds after the pouch is open.



- 6** Smooth and rub the surface to achieve good contact between layers. In 3-5 minutes after immersion in the water, Tomato Cast is sufficiently cured for further molding.

PRODUCT INFORMATION

CODE NO.	SIZE	ROLLS / BOX
TRC-002F/TRC-002P	2in × 4yds (5.0cm × 3.6m)	10
TRC-003F/TRC-003P	3in × 4yds (7.5cm × 3.6m)	10
TRC-004F/TRC-004P	4in × 4yds (10.0cm × 3.6m)	10
TRC-005F/TRC-005P	5in × 4yds (12.5cm × 3.6m)	10
TRC-006F/TRC-006P	6in × 4yds (15.0cm × 3.6m)	10

COLOR INDEX



*The color shown in the picture may be different from the actual color.

ORDERING CODE

TRC - 00XX - XX

COLOR INDEX

F: FIBERGLASS / P: POLYESTER

WIDTH

TRC: TOMATO RIGID CAST

TSC: TOMATO SOFT CAST

* e.g. - TRC - 003F - WH: tomato rigid cast, 3 inch, fiberglass, white

Removal: Tomato Cast can be removed with a traditional cast saw. Care should be taken to avoid injury to the patient when a small amount of underpadding has been used.



Top Management for Tomorrow

INTENTION TO USE

Tomato Cast has been designed for immobilization of fractures, sprains and strains, ect.

PRECAUTION

1. Each roll should be gently squeezed prior to opening to check suitability for application. The unopened roll should be soft and flexible, Do not use the roll that feels hard.
2. The polyurethane resin could adhere firmly to unprotected skin, hair and clothing, which may cause a mild irritation. Thus, always wear protective gloves to apply and use alcohol or acetone before to remove the polymer.
3. An uncomfortable increase of heat can be caused during hardening by excessive layering of tape or immersing in water at temperature above 27°C.
4. All application should be followed instructions and directions of a doctor or qualified medical professional.
5. Products should be stored out of reach of children.



Tomato SOFT CAST™

FEATURES

- Easy to be cut off by bandage scissors
- Enough fixation for support
- Skin Tight applications without padding
- Shoes can be worn with the cast on
- Suitable for a child in cast removal



INTENTION TO USE

Tomato Soft Cast is intended for secondary casting and a comprehensive wrap to control swelling. Tomato Soft Cast, more flexible casting material is typically used for functional immobilizations that can tolerate some movement (ex. minor broken bones, or more casual strains, sprains, and **ligament damage**).

PRODUCT CHARACTERISTICS

Tomato Soft Cast consists of a knitted polyester fabric impregnated with a polyurethane resin. Exposure to moisture or water initiates a chemical reaction which causes the roll to set. The finished wrap will retain its shape while remaining elastic to the touch

PRODUCT INFORMATION

CODE NO.	DESCRIPTION	SIZE	ROLLS/BOX
TSC- 002P	Tomato Soft Polyester Cast	2in × 4yds(5cm × 3.6m)	10rolls
TSC-003P	Tomato Soft Polyester Cast	3in × 4yds(7.5cm × 3.6m)	10rolls
TSC-004P	Tomato Soft Polyester Cast	4in × 4yds(10cm × 3.6m)	10rolls
TSC-005P	Tomato Soft Polyester Cast	5in × 4yds(12.5cm × 3.6m)	10rolls

Top Management for Tomorrow

Tomato ^{Super} PATTERNED CAST™

FEATURES

- To be used to improve effective treatment through a patient's state of balance
- Cartoon Pattern can catch children's eyes.
- Military Pattern can be disguised from enemy



BASIC 5 PATTERNS

Flower, Panda, Camo blue, Camo pink, Camo green



Tomato ^{Super} SPLINT™

FEATURES

- Comfortability & hygiene: Instead of soaking in the water, as water spray is possible on the mesh part, it gives more pleasant feeling to the patient because there is no water on patient side.
- Conformability & mouldability: Tomato Splint is very easy to shape the contours of human body.

APPLICATION INSTRUCTIONS

Please refer to our websites (www.tomatomnc.com) for instruction video and more details.

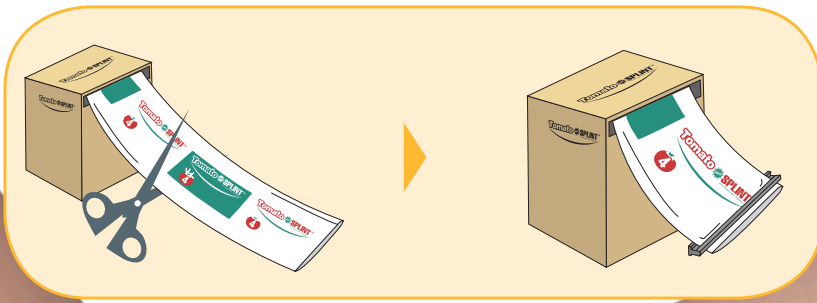

1A Take out Tomato Splint covered with long sealed foil pouch from the box, measure the length to apply and cut off with a bandage scissors.

1A-1 Seal up immediately with a clip (sealing bar) provided inside each box to prevent air of moisture from coming inside the package.



2 Choose the desired size for the affected body part. Generally no gloves are necessary.



3 Open the product and immerse the Tomato Splint in the room temperature water for 3-5 seconds and squeeze 3 to 4 times to complete penetration of water into the body of the Splint.

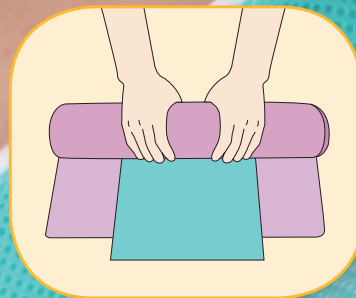

4 Get rid of the excessive water on the splint to strengthen adhesion between the layers, laying it on the dry towel and roll up with the towel.



5 Wrap Tomato Splint with a roll of elastic bandage to secure and mold it freely.



Top Management for Tomorrow

INTENTION TO USE

Tomato Splint has been designed for use in emergency treatment for fractures, sprains and strains. Common practices are, after fractures, swelling would cause a cast to function improperly. Tomato Splint can be used until swelling has been decreased and ready to apply complete cast.

PRODUCT INFORMATION

PRODUCT CODE	TYPE	SIZE	EA / BOX
TPS-210F/TPS-210P	PRE - CUT	2 in x 10 in (5.0 cm x 25.0 cm)	10
TPS-312F/TPS-312P	PRE - CUT	3 in x 12 in (7.5 cm x 30.0 cm)	10
TPS-335F/TPS-335P	PRE - CUT	3 in x 35 in (7.5 cm x 87.5 cm)	10
TPS-415F/TPS-415P	PRE - CUT	4 in x 15 in (10.0 cm x 37.5 cm)	10
TPS-430F/TPS-430P	PRE - CUT	4 in x 30 in (10.0 cm x 75.0 cm)	10
TPS-530F/TPS-530P	PRE - CUT	5 in x 30 in (12.5 cm x 75.0 cm)	10
TPS-545F/TPS-545P	PRE - CUT	5 in x 45 in (12.5 cm x 112.5 cm)	5
TPS-630F/TPS-630P	PRE - CUT	6 in x 30 in (15.0 cm x 75.0 cm)	10
TPS-645F/TPS-645P	PRE - CUT	6 in x 45 in (15.0 cm x 112.5 cm)	5
TRS-002F/TRS-002P	ROLL	2 in x 5 yds (5.0 cm x 450 cm)	1
TRS-003F/TRS-003P	ROLL	3 in x 5 yds (7.5 cm x 450 cm)	1
TRS-004F/TRS-004P	ROLL	4 in x 5 yds (10.0 cm x 450 cm)	1
TRS-005F/TRS-005P	ROLL	5 in x 5 yds (12.5 cm x 450 cm)	1
TRS-006F/TRS-006P	ROLL	6 in x 5 yds (15.0 cm x 450 cm)	1

ORDERING CODE

TPS - XXXX

TRS - 00XX

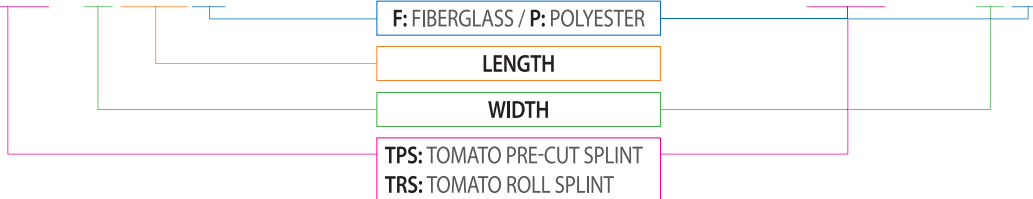

- * e.g. - TPS - 312P: Tomato pre-cut type splint, 3 in x 12 in, polyester
- * e.g. - TRS - 004F: Tomato roll type splint, 4 inch, fiberglass



For easy cutting, there is a measurement marking on the side of the cover at 2cm intervals.



EVAPORATION DURING THE HARDENING PROCESS

This picture evidences that our splint evaporates during the hardening process. This makes patients' condition most comfortable.

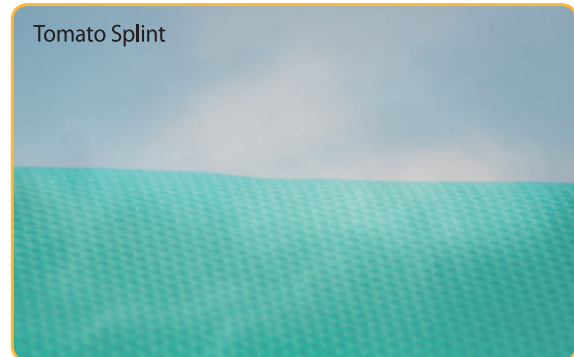

※ Test Condition : Temperature $-10\pm 1^{\circ}\text{C}$

AFTER USE

This picture evidences that Tomato splint was polluted less than General Splint's one even after use. Because our mesh type fabric dries fast.



PRECAUTION

1. Each product should be gently squeezed prior to opening to check suitability for application. The unopened product should be soft and flexible. Do not use the product that feels hard (for the roll type splint if the edge is hardened after resealing, cut off the hardened part and use remaining soft part).
2. Wearing surgical gloves does not need to handle the splint. But the polyurethane resin could adhere firmly to unprotected skin, hair and clothing, which may cause a mild irritation. Thus, wearing protective gloves are recommended to apply in case you need to touch the polyurethane part and use alcohol or acetone to remove the polymer.
3. An uncomfortable increase of heat can be caused during hardening by immersing in water at temperature above 27°C .
4. All application should be followed instructions and directions of a doctor or qualified medical professional.
5. Products should be stored out of reach of children.

Tomato ^{Super} SAFE PAD™

FEATURES

- **Comfortability**
Tomato ^{Super} SAFE PAD™ reduces the water absorption and dries quickly to keep a patient more comfortable.
- **Excellent Air Permeability**
Tomato ^{Super} SAFE PAD™ is well ventilated and reduces skin irritation caused by sweat and moisture.
- **Superior Cushioning**
Tomato ^{Super} SAFE PAD™ cushions the impact effectively.

PRODUCT CHARACTERISTICS

- Tomato ^{Super} SAFE PAD™ is the product mixed with PAD and STOCKINET and consists of polyester fabric.
- Tomato ^{Super} SAFE PAD™ is easy to use and reduces the medical treatment time.
- Tomato ^{Super} SAFE PAD™ protects the affected area and skin when CAST is removed by CAST SAW.

PRECAUTION

- Tomato ^{Super} SAFE PAD™ reduces the water absorption, but avoid taking a sauna or shower without a doctor's permission.
- Excessive actions can lead to a worse injury.



PRODUCT INFORMATION

CODE NO.	DESCRIPTION	SIZE	ROLLS / BOX
TRP-002	TOMATO ROLL PAD	2in X 10m	1
TRP-003	TOMATO ROLL PAD	3in X 10m	1
TRP-004	TOMATO ROLL PAD	4in X 10m	1
TRP-005	TOMATO ROLL PAD	5in X 10m	1
TRP-006	TOMATO ROLL PAD	6in X 10m	1

Tomato ^{Super} PAD™

FEATURES

- Extreme softness with volume makes superior comfortability
- Once binding up, won't be come off easily
- 100% Cotton minimizes skin troubles

INTENTION TO USE

Tomato ^{Super} PAD™ is intended as a soft sores-preventing inter-layer under solid casting tape.



PRODUCT CODE	SIZE
TMP-002	Orthopedic pad 2"×2.7m, 100% cotton
TMP-003	Orthopedic pad 3"×2.7m, 100% cotton
TMP-004	Orthopedic pad 4"×2.7m, 100% cotton
TMP-006	Orthopedic pad 6"×2.7m, 100% cotton
TMP-008	Orthopedic pad 8"×2.7m, 100% cotton

Tomato STOCKINET™

FEATURES

- Soft & moderate elasticity offers more comfortability to patient
- 100% Cotton minimizes skin troubles

INTENTION TO USE

Tomato STOCKINET is intended as a soft sores-preventing inter-layer under solid cast materials.



PRODUCT CODE	SIZE
TMS-002	100% cotton stockinette 2"×10m
TMS-003	100% cotton stockinette 3"×10m
TMS-004	100% cotton stockinette 4"×10m
TMS-006	100% cotton stockinette 6"×10m
TMS-008	100% cotton stockinette 8"×10m
TMS-010	100% cotton stockinette 10"×10m

Tomato ELASTIC BANDAGE™

FEATURES

- You can choose either 100% Cotton or 95% Cotton and 5% Rubber case by case.
- Providing breathing comfort in case of bandaging of torso thanks to its elasticity
- Allowing unconstrained movement after bandaging of knee or elbow joint.
- Good value for the money as the amount of usage is less

INTENTION TO USE

Tomato ELASTIC BANDAGE is intended as holding the splint in place and to protect it.



PRODUCT CODE	SIZE
TME-002R/TME-002C	5cm x 2.15m
TME-003R/TME-002C	7.5cm x 2.15m
TME-004R/TME-002C	10cm x 2.15m
TME-006R/TME-002C	15cm x 2.15m



sales@tomatomnc.kr | www.tomatomnc.com

Tomato  CAST™ Tomato  SOFT CAST™ Tomato  PATTERNED CAST™
 Tomato  SPLINT™ Tomato  SAFE PAD™ Tomato  PAD™
 Tomato  STOCKINET™ Tomato  ELASTIC BANDAGE™ are made in Korea